

275 sq. ft.
OF WORK
SPACE



MOBILE FIREGROUND REHAB CENTER



COMMANDER REHAB

EXPANDABLE TRAILER TECHNOLOGY

- BUILT TOUGH
- QUICK SETUP
- EASY TRANSPORT



Create a central hub from which all responder rehabilitation operations are administered! The health and well-being of firefighters, EMS and other first response personnel is often overlooked despite the grueling requirements their minds and bodies are put under everyday. Safeguard their lives with the Commander Rehab from Nor E, the fireground rehab trailer designed by firefighters for firefighters. The Commander Rehab provides the self-contained, environmentally controlled work space to effectively monitor and care for their needs on-site, including rest, rehydration, medical care, shower and restroom facilities. The Commander Rehab is easy to transport and setup--it takes less than 5 minutes! Get the unit that's been proven effective that customers have called "worth every penny" and credited with "saving firefighters' lives."



COMMANDER REHAB

EXPANDABLE TRAILER TECHNOLOGY
20-FOOT, 275-SQUARE-FEET

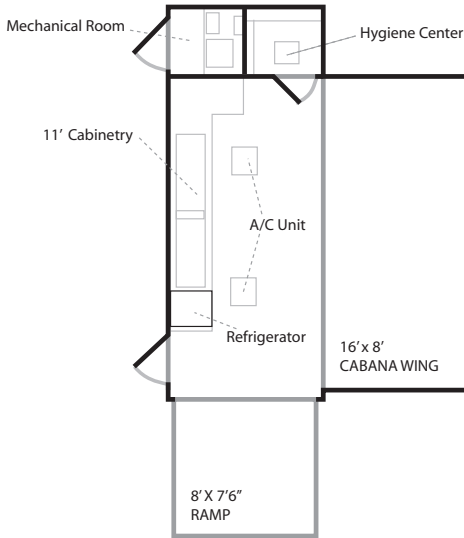

REHAB CENTER FEATURES:

- Compact 160 sq. ft. utility size trailer quickly becomes 275 sq. ft. of environmentally controlled rehab space
- Curbside Cabana wing expands seating and rehab space without blocking traffic on driver's side
- Hygiene center with tub style shower floor and integrated toilet, black water holding tank and ceiling fan accessed from inside
- 11' of upper and lower cabinetry for supplies and consumables storage
- Under counter refrigerator for beverages and medical supplies
- 30,000 Btu air conditioning w/ heat pumps
- Weather protection strips on both rear ramp and side man-door entries
- Exterior driver's side 7' x 12' awning
- Tough floor coating with easy to clean wall surfaces

FEATURES (cont.)

- 8' X 20' fully insulated body with one 7' X 16' curb side Cabana Wing
- 2 5/6" ball coupler with D.O.T. compliant safety devices
- Dual 5000 lb. axles with polished aluminum wheels and electric brakes (10,000 GVWR, actual trailer is +/- 6500 lbs.)
- 3000 lb. leveling jacks at each corner
- Fully undercoated chassis
- Front mechanical room with driver side man door housing mechanical systems including: generator, power panel, water heater, pumps, fresh water holding tank, fuel day tank (mounted above tandem axles)
- Wall mounted operational control panel
- Hygiene center with tub style shower floor and integrated toilet, black water holding tank and ceiling fan accessed from inside
- Interior walls and ceiling finished in white FRP liner
- Heavy duty hospital grade flooring
- Lower and upper cabinets with drawers in "L" configuration on inside driver side wall
- Stainless steel double sink in front wall counter
- Floor mounted tie-down rings (6)
- 12V and 120V lighting
- Twin 15,000 Btu roof mounted HVAC or single exterior mounted ECU unit
- Rear driver side entry man door
- All exterior LED lighting
- Folding entry step for exterior man door

OPTIONS

- 10 kW to 12.5 kW generator upgrade
- Exterior telescoping lights
- Hepifilter
- Portable ramp
- Custom wiring chases
- Custom cabinetry and appliances

COMMANDER REHAB

Trailer Dimensions	20'1" x 8'4" w x 10'9" h
Curb Weight	6500 lbs.
Trailer Axles	(2) 5,000 lb.
Trailer Brakes	Electric w/ breakaway battery
Wheels	Aluminum
Tires	Radial, (1) spare
Stabilization Jacks	(4)
Drop Leg Jack	8,000 lb. w/ sand pad
Ball Coupler	2 5/16" w/ D.O.T. safety devices
Interior	FRP walls, hospital grade vinyl floors
Lighting	12V and 120V
Exterior Lighting	L.E.D.
Fire Extinguisher	(1) 10 lb.
Operations Manual	(1)

1-866-380-8455 | www.nor-e.com | info@nor-e.com